

**St George's Day Parade & Service**  
**Parent's Information**  
**Sunday 27<sup>th</sup> April 2025**

All young people attending will need to wear full smart uniform this includes:

- Uniform sweatshirt or shirt
- Group neckerchief
- Uniform trousers or Smart school trousers – black, navy or grey
- Smart black school shoes
- Coat (if needed for adverse weather)

There will be a collection for the Bone Cancer Research Trust & Strode Park Foundation as this year's charities, please bring any donations and pass to leaders on arrival.

[Home | Bone Cancer Research Trust](#) / [Home - Strode Park Foundation - Kent charity](#)

Plan of the Afternoon

1. 1:40pm Meeting in **Westgate Gardens** – find your group.
2. 2:00pm Bands and colour guard will form up – Please note only volunteer leaders and marshals should be part of the parade. Parents should not walk with their young people but line the route (see map below). This is the ideal time to go and find your spot.
3. 2:10-2:40pm Parade from Westgate Gardens to Canterbury Cathedral.
4. 2:45pm Flags line up outside of West Door while Parade circles the precincts before entering and taking their seats.
5. A limited number (we have over 1000 young people attending) of parents will be allowed to enter and be seated once all children are in – please don't enter until invited – once inside please be seated promptly.
6. 2:55pm Flags will enter the Cathedral through West Door, with Colour Guard leading and music from Sea Scouts Band.
7. 3:00pm The service will begin.
8. 4:00pm The service will end and children will be formally dismissed.
9. Parents will be dismissed after all young people so please remain seated until invited to leave. This is so Leaders can move with young people to your safe pick up location. Please see collection plan below.

## Westgate Gardens Line Up – Line up 3 wide

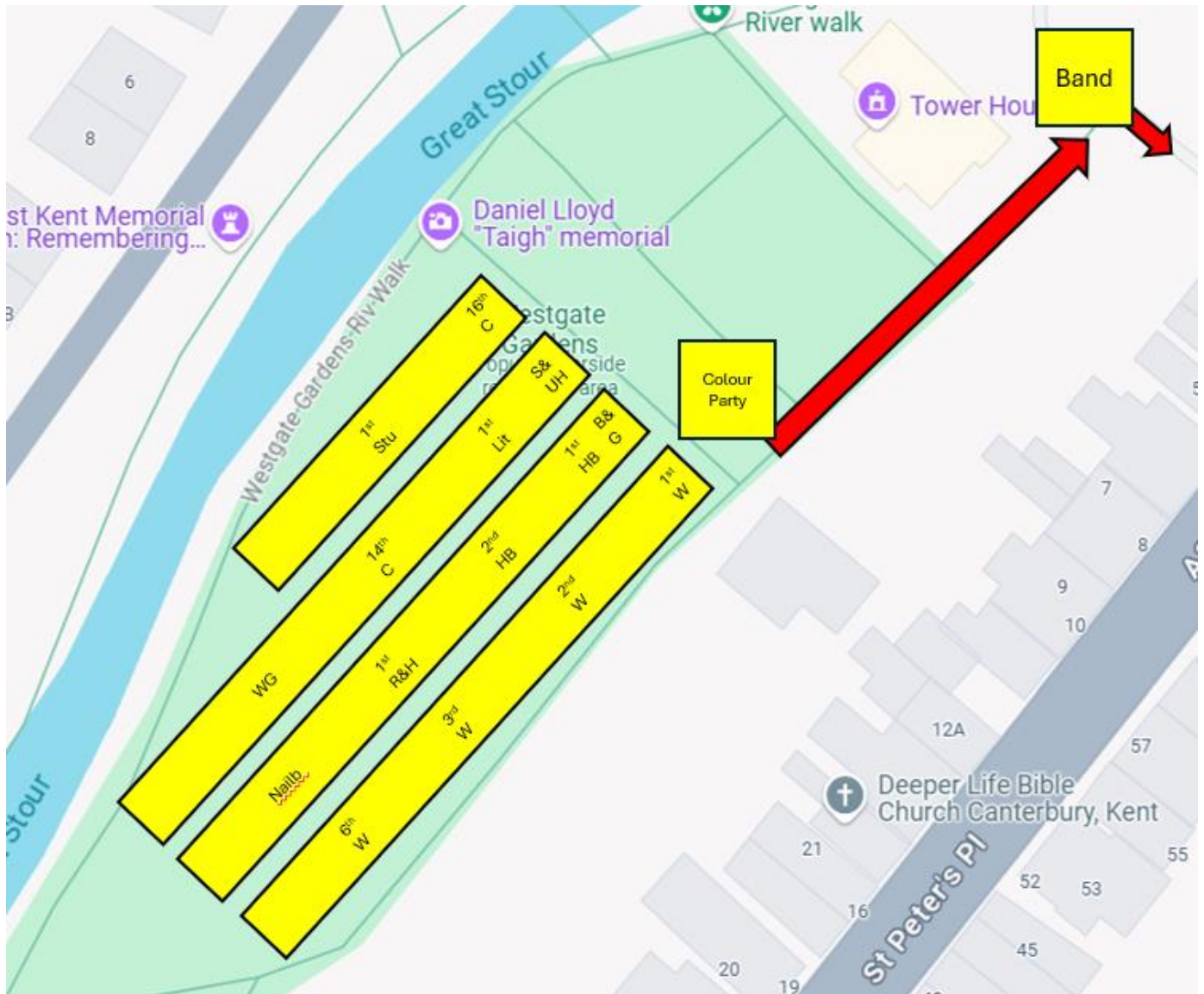



## Parade Route Diagram

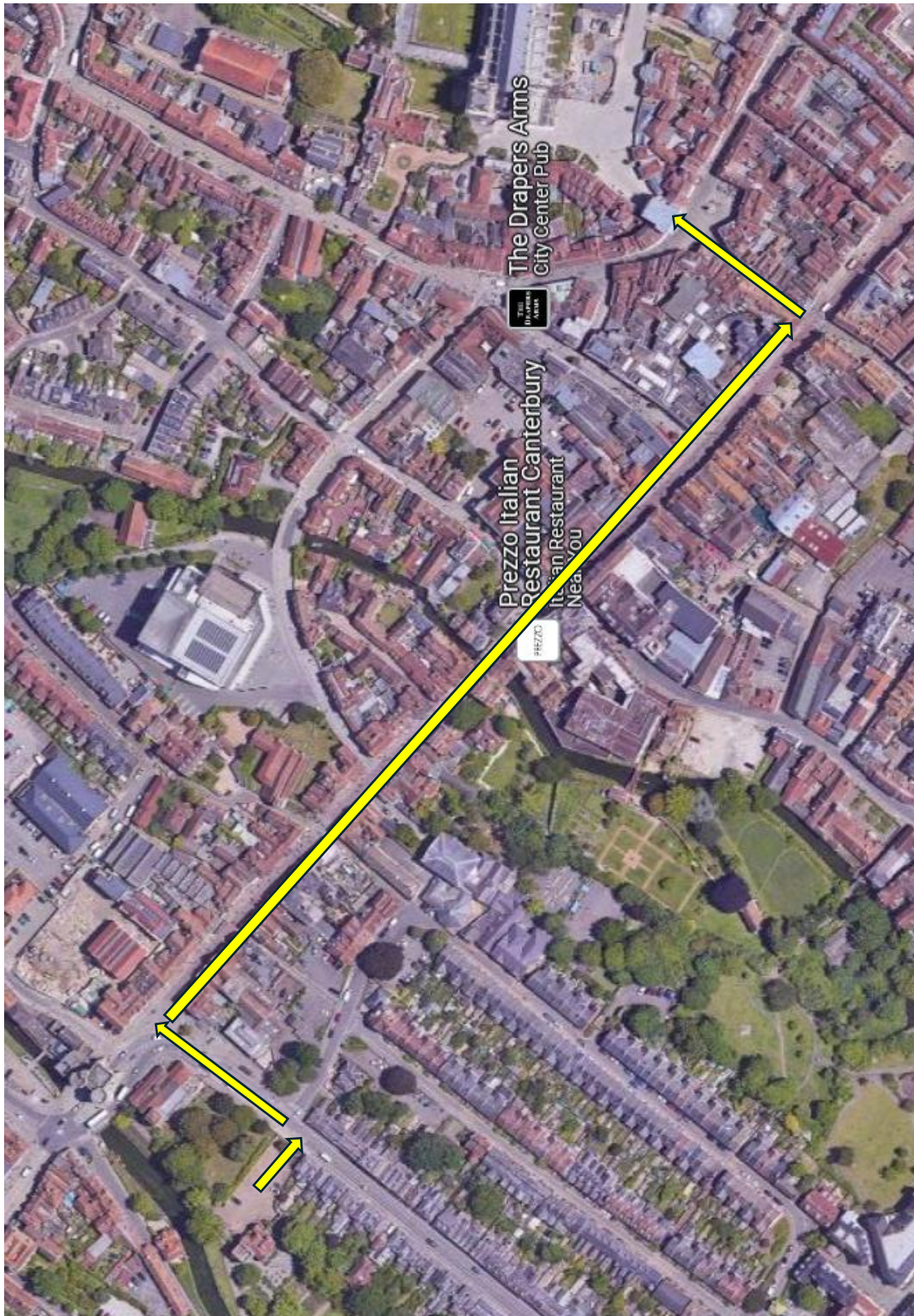

Leave Westgate Gardens through to Tower House Car Park  
Leave Tower House Car Park and turn left onto St Peter's Place  
Approach corner of high street – turn right  
Walk up the High Street and turn left into Mercery Lane  
Across and through the Christ Church Gate to the Cathedral  
Loop inside the Cathedral grounds to allow flag bearers to get in place.



## Collection Points

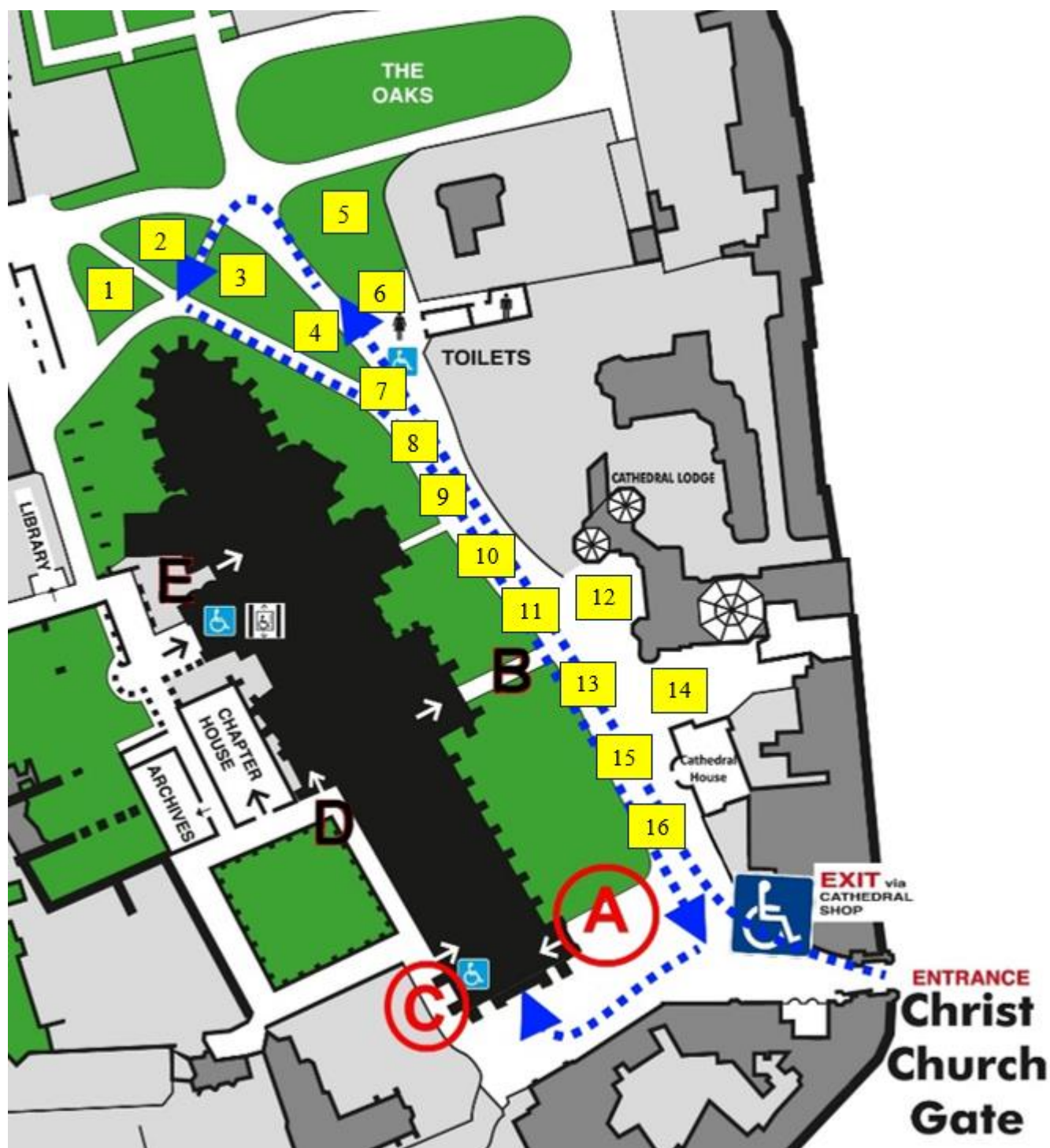

1. 1<sup>st</sup> Whitstable
2. 3<sup>rd</sup> Whitstable
3. 6<sup>th</sup> Whitstable
4. 1<sup>st</sup> Herne Bay
5. 2<sup>nd</sup> Whitstable
6. Band
7. 2<sup>nd</sup> Herne Bay
8. 1<sup>st</sup> Reculver & Herne

9. Brownies & Guides
10. Nailbourne
11. Stelling & Upper Hardres
12. 1<sup>st</sup> Littlebourne
13. 14<sup>th</sup> Canterbury
14. Worthgate
15. 16<sup>th</sup> Canterbury
16. 1<sup>st</sup> Sturry